

# PRONTO-250

0.5 W - 250 W Power Probes with Touch Screen Controls



## KEY FEATURES

- POCKET-SIZE**  
This mid to high power laser probe is so compact it fits in your pocket!
- EASY-TO-USE**  
The touch screen color LCD allows for a friendly user interface. You can make a measurement with just the touch of a button!
- DATA LOGGING**  
Save your data to the internal memory and then transfer it to your PC over the USB connection.
- FROM LOW TO HIGH POWERS**  
Thanks to a low noise level and high damage threshold, the Pronto can measure powers from 0.5 W to 250 W.
- YAG AND CO<sub>2</sub> CALIBRATIONS**  
The Pronto-250 comes fully calibrated: every wavelength between 248 nm and 2.5  $\mu\text{m}$  (YAG), and a real calibration at 10.6  $\mu\text{m}$  (CO<sub>2</sub>).  
The Pronto-250-PLUS has an additional calibration for Single-Shot Energy measurements.
- HANDS-FREE OPERATION**  
Place it on a flat surface or use one of the 2 threaded holes for safe use with optical stands.
- NEW SERIAL COMMANDS**  
Serial commands are available to let you take full control of your Pronto from your PC.

## USER INTERFACE (SSP MODE)

Make a measurement in just a few seconds

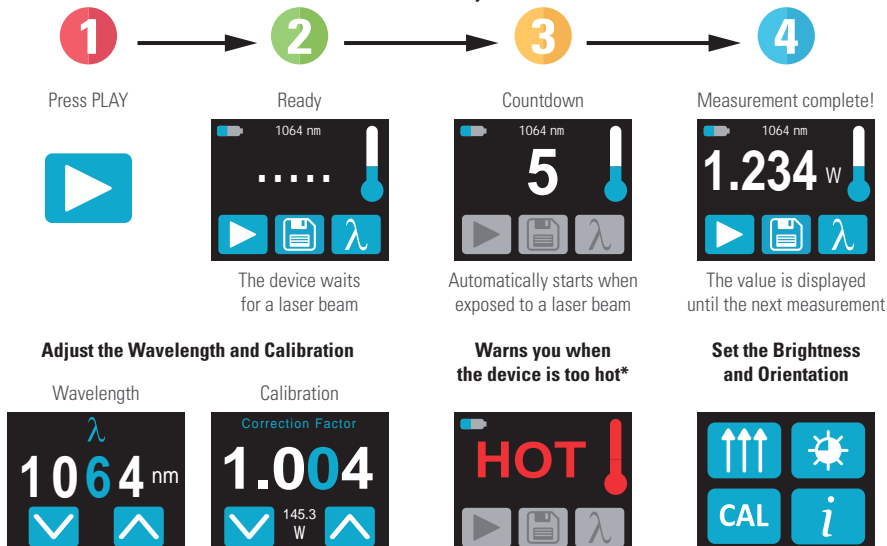

## 2 MODELS FOR ALL YOUR MEASUREMENT NEEDS

The regular **Pronto-250** is very easy to use and will give you accurate one shot measurements, thanks to its unique Measurement Mode:

- Single Shot Power (SSP): Up to 250 W

The new **Pronto-250-PLUS** model comes with 3 Measurement Modes and can be used in a variety of applications:

- Single Shot Power (SSP): Up to 250 W
- Continuous Power (CWP): Up to 8 W
- Single Shot Energy (SSE): Up to 25 J



\* Device may get hot, it is not recommended for handheld use when making a measurement

# PRONTO-250



\*Also traceable to NRC-CNRC

## SPECIFICATIONS

PRONTO-250		PRONTO-250-PLUS		
		SSP Mode Measures in 5 sec	CWP Mode Measures Power continuously	SSE Mode Measures in less than 0.5 sec
MAX AVERAGE POWER/ENERGY	250 W	250 W	8 W	25 J (up to 150 J for pulses >1 ms)
EFFECTIVE APERTURE	19 mm Ø	19 mm Ø		
INTERFACE	Touch Screen Color LCD Display	Touch Screen Color LCD Display		
<b>MEASUREMENT CAPABILITY</b>				
Spectral Range	0.19 - 20 µm	0.19 - 20 µm		
Calibrated Spectral Range	0.248 – 2.5 µm and 10.6 µm	0.248 – 2.5 µm and 10.6 µm		
Noise Equivalent Power/Energy	10 mW	10 mW	10 mW	60 mJ
Minimum Measurable Power/Energy	0.5 W	0.5 W	0.2 W	N/A
Exposure Time	5 sec	5 sec	1.5 sec response time	0.26 sec
Measurement Accuracy	± 3 %	± 3 %	± 2.5 %	± 5 %
Min Repetition Period (Max Pulse Width)	N/A	N/A	N/A	4 sec (88 ms)
Display Resolution	1 mW	1 mW	1 mW	10 mJ
<b>DAMAGE THRESHOLDS</b>				
Maximum Average Power Density <sup>a</sup>	45 kW/cm <sup>2</sup> (at 1064 nm, 10 W, CWP) / 14 kW/cm <sup>2</sup> (at 10.6 µm, 10 W, CWP)			
Maximum Exposure Time <sup>b</sup>	6 sec	6 sec	N/A	N/A
Maximum Device Temperature <sup>b</sup>	65°C	65°C	40°C	40°C
<b>USER INTERFACE</b>				
Measurement Controls	Wavelength Selection and User Calibration			
Measurement Modes	Single Shot Power (SSP)	Single Shot Power (SSP), Continuous Power (CWP) and Single Shot Energy (SSE)		
Data Acquisition and Transfer	Simple On/Off Controls, saves to on-board memory and transfers data to the PC using the USB connection			
Screen Personalization	Orientation and Brightness controls			
Battery Indicator	On-screen indicator with 4 levels			
<b>GENERAL SPECIFICATIONS</b>				
Display Type	Touch Screen Color LCD	Touch Screen Color LCD		
Display Size	28.0 x 35.0 mm (128 x 160 pixels)	28.0 x 35.0 mm (128 x 160 pixels)		
Backlight	Adjustable	Adjustable		
Internet Upgrades Via	USB port	USB port		
Data Storage	50,000 pts	50,000 pts		
Battery Type	Rechargeable Li-ion	Rechargeable Li-ion		
Battery Life	17 hours or 4 200 measurements (with brightness set at 25%)	17 hours or 4 200 measurements (with brightness set at 25%)		
Battery Recharge Via	USB port	USB port		
Operating Temperature Range	15 - 28 °C (max 80% RH)	15 - 28 °C (max 80% RH)		
<b>PHYSICAL CHARACTERISTICS</b>				
Effective Aperture	19 mm Ø	19 mm Ø		
Absorber	H9	H9		
Mounting Holes (for Post)	2 x 8-32	2 x 8-32		
Dimensions	59.0W x 181.4L x 17.0D	59.0W x 181.4L x 17.0D		
Weight	210 g	210 g		
<b>ORDERING INFORMATION</b>				
Product Name	PRONTO-250	PRONTO-250-PLUS		
Product Number (without stand)	202917	203208		

Specifications are subject to change without notice // Compatible stand: P/N 200160

a. To get all the damage thresholds, see User Manual

# PRONTO-50

0.5 W - 50 W Power Probes with Touch Screen Controls

NEW



## KEY FEATURES

- 1. POCKET-SIZE**  
This mid-power laser probe is so compact it fits in your pocket!
- 2. EASY-TO-USE**  
The touch screen color LCD allows for a friendly user interface. You can make a measurement with just the touch of a button!
- 3. USER SETTABLE**  
You can set the wavelength, brightness and screen orientation to adapt to your application.
- 4. DATA LOGGING**  
Save your data to the internal memory and then transfer it to your PC over the USB connection.
- 5. IDEAL FOR TIGHTLY FOCUSED BEAMS**  
The specialized, very high damage threshold absorber is perfect for high power densities.
- 6. HANDS-FREE OPERATION**  
Place it on a flat surface or use one of the 2 threaded holes for safe use with optical stands.
- 7. SERIAL COMMANDS**  
Serial commands are available to let you take full control of your PRONTO from your PC.

## USER INTERFACE (SSP MODE)

Make a measurement in just a few seconds

1

Press PLAY



2

Ready

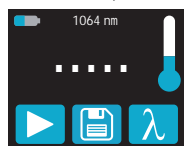

The device waits for a laser beam

3

Countdown



Automatically starts when exposed to a laser beam

4

Measurement complete!

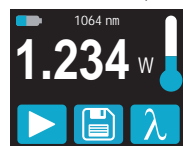

The value is displayed until the next measurement

Adjust the Wavelength and Calibration

Wavelength



Calibration

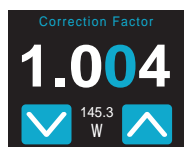

Warns you when the device is too hot\*



Set the Brightness and Orientation

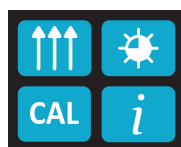

## HAND-FREE



## DATA TRANSFER TO PC



# PRONTO-50

## SPECIFICATIONS

NEW

PRONTO-50-W5

MAX AVERAGE POWER/ENERGY	50 W
EFFECTIVE APERTURE	19 mm Ø
INTERFACE	Touch Screen Color LCD Display

### MEASUREMENT CAPABILITY

Spectral Range	0.19 - 10 µm
Calibrated Spectral Range	0.248 – 2.5 µm
Noise Equivalent Power/Energy	4 mW
Minimum Measurable Power/Energy	0.5 W
Response Time	5 sec
Measurement Accuracy	± 3 %
Min Repetition Period	15 Hz
Display Resolution	1 mW

### DAMAGE THRESHOLDS

Maximum Average Power Density <sup>a</sup>	100 kW/cm <sup>2</sup> (at 1064 nm, 10 W, CW)
Maximum Exposure Time <sup>b</sup>	6 sec
Maximum Device Temperature <sup>b</sup>	65°C

### USER INTERFACE

Measurement Controls	Wavelength Selection and User Calibration
Measurement Modes	Single Shot Power (SSP)
Data Acquisition and Transfer	Simple On/Off Controls, saves to on-board memory and transfers data to the PC using the USB connection
Screen Personalization	Orientation and Brightness controls
Battery Indicator	On-screen indicator with 4 levels

### GENERAL SPECIFICATIONS

Display Type	Touch Screen Color LCD
Display Size	28.0 x 35.0 mm (128 x 160 pixels)
Backlight	Adjustable
Internet Upgrades Via	USB port
Data Storage	50,000 pts
Battery Type	Rechargeable Li-ion
Battery Life	17 hours or 4 200 measurements (with brightness set at 25%)
Battery Recharge Via	USB port
Operating Temperature Range	15 - 28 °C (max 80% RH)

### PHYSICAL CHARACTERISTICS

Effective Aperture	19 mm Ø
Absorber	W5
Mounting Holes (for Post)	2 x 8-32
Dimensions	59.0W x 181.4L x 17.0D
Weight	210 g

### ORDERING INFORMATION

Product Name	PRONTO-50-W5
Product Number (without stand)	203794

Specifications are subject to change without notice // Compatible stand: P/N 200160

a. To get all the damage thresholds, see User Manual

b. At maximum power